



# TREADWELL PARK

upper east side

Our passion is beer, and we love sharing the best with our friends and neighbors. Our craft beer hall offers 20 rotating craft draft beers and ciders delivered by our on-site flux capacitor, and you'll find beer in some of our cocktails, as well as in our delicious ice cream floats.

1125 1ST AVENUE, NY, NY 10065



# TREADWELL PARK

upper east side

## EAT & DRINK

Treadwell Park offers 20 rotating draught craft beers and ciders, cask beers, and hand crafted artisanal cocktails. Celebrated independent spirits and distilleries. Fulfills every craving with an innovative menu of bar classics and exotic bites. Remember to laugh and have a lot of fun!

## EVENTS

The 7,000 square foot beer hall and gastropub will seat 200 guests indoor  
Platters, passed hors d'oeuvres, buffet, open bar, specialty cocktails and beers

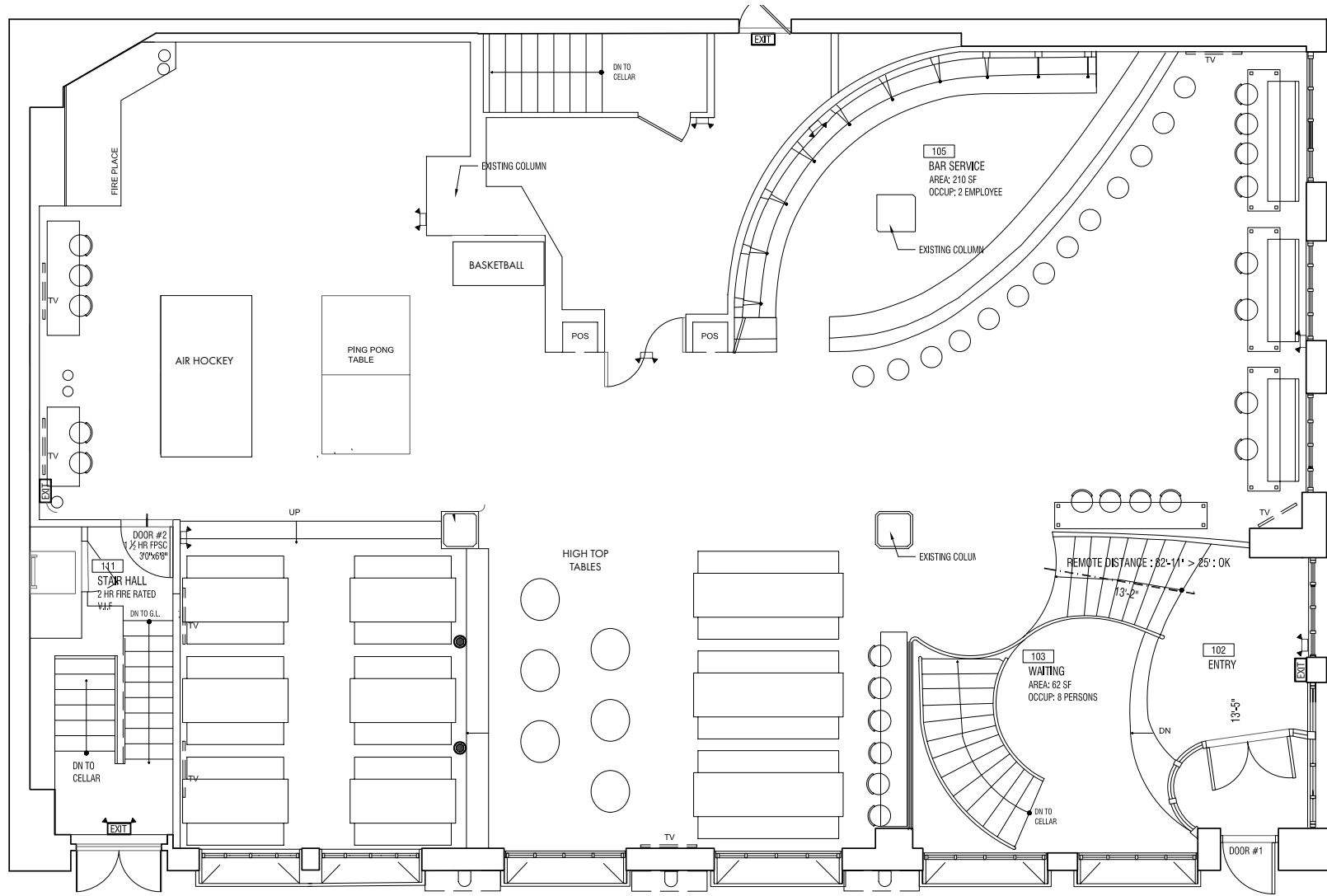

# TREADWELL PARK

upper east side

**\*Full Buyout**

\*depending on the season | date up

**\$20,000 to \$40,000**

**250 People Cocktail Style Reception | 3 Hours**

**MENUS | INQUIRE**

**Celine Labarre**  
Event Manager

Tel: 212.871.4000 ext.3300

celine@merchantshospitality.com